

3/8" THICK MILD STEEL
 WITH Ø9/16" HOLE OR
 1/4" THICK STAINLESS
 WITH Ø7/16" HOLE

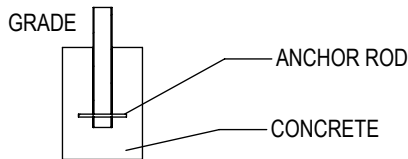

□ IN GROUND MOUNT (IG)

CHECK DESIRED MOUNT

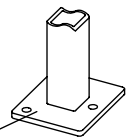
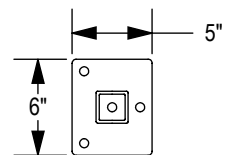

□ SURFACE FLANGE MOUNT (SF)

PRODUCT: CS200-11-IG(SF)
 DESCRIPTION: CAPITOL SQUARE BIKE RACK
 11 BIKE, SURFACE OR IN GROUND MOUNT
 DATE: 4-24-19
 ENG: SMC

CONFIDENTIAL DRAWING AND INFORMATION IS NOT TO BE COPIED OR DISCLOSED TO OTHERS WITHOUT THE CONSENT OF GRABER MANUFACTURING, INC. SPECIFICATIONS ARE SUBJECT TO CHANGE WITHOUT NOTICE.

NOTES:

1. INSTALL BIKE RACKS ACCORDING TO MANUFACTURER'S SPECIFICATIONS.
2. CONSULTANT TO SELECT COLOR (FINISH), SEE MANUFACTURER'S SPECIFICATIONS.
3. SEE SITE PLAN FOR LOCATION OR CONSULT OWNER.