

3/8" THICK MILD STEEL
WITH Ø 9/16" HOLE OR
1/4" THICK STAINLESS
WITH Ø 7/16" HOLE

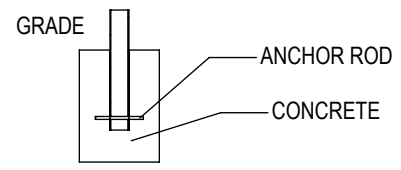

IN GROUND MOUNT (IG)

CHECK DESIRED MOUNT

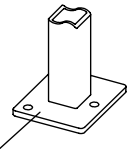
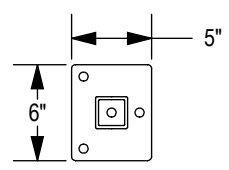

SURFACE FLANGE MOUNT (SF)

PRODUCT: CS200-7-IG(SF)
DESCRIPTION: CAPITOL SQUARE BIKE RACK
7 BIKE, SURFACE OR IN GROUND MOUNT

DATE: 4-24-19
ENG: SMC

CONFIDENTIAL DRAWING AND INFORMATION IS NOT TO BE COPIED OR DISCLOSED
TO OTHERS WITHOUT THE CONSENT OF GRABER MANUFACTURING, INC.
SPECIFICATIONS ARE SUBJECT TO CHANGE WITHOUT NOTICE.

- NOTES:
1. INSTALL BIKE RACKS ACCORDING TO MANUFACTURER'S SPECIFICATIONS.
 2. CONSULTANT TO SELECT COLOR (FINISH), SEE MANUFACTURER'S SPECIFICATIONS.
 3. SEE SITE PLAN FOR LOCATION OR CONSULT OWNER.